



# RADBIO Technologies







# RADBIO Technologies

## POWERING THE SCIENCE OF GROWTH

Stimulate root development & uniform plant growth  
AI-CONTROLLED EMF SYSTEM

The advanced LSR Electromagnetic LSR500 Series. The feedback-sensitive probes are controlled with the patented AI system and can be connected plug & play with the onboard resonance generator of the LSR500 series. Inserted into the substrate they produce low electromagnetic frequencies, which are stimulating the plants' root development and uniform plant growth and are to a certain extent even shielding your plants from undesired electromagnetic influences. Each LSR Electromagnet resonance probe can cover up to 3m<sup>3</sup> space and is resistant to high humidity. The probes can be inserted into soil or hydroponics directly, are easy to clean, and even easier to install

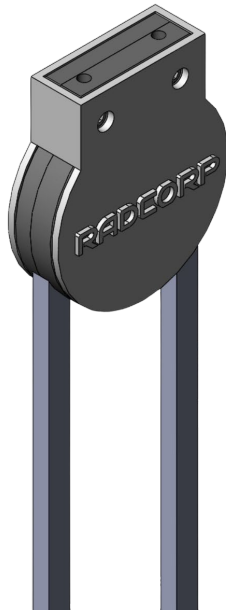

SKU: Earth Sense Probes (ESP) Field Effect

Type	Electromagnetic Probes
Control	Via Mobile App
Scalability	Up to 6 pcs per LSR
Power	0.05 mW (+/- 5%)*
Dimensions	250 x 12 x 12 mm
Coverage (1pcs)	(1,45 x 1,45 x 1,45?) 3m3
Ambient temp.	0°C to 50°C (95% RH)
Storage conditions	0°C to 60°C (85% RH)
Protection Class	IP65
Isolation class	Class I
Life span	> 50,000 operating hours (2)
Material	PVC \ Copper
Finish	Precious metal plating
Weight	6.4 kg (+/- 0.2kg)
Power supply	Plug & play
Plug & play accessories	ADVANCE LSR500

